

Mobile enrollment backpack

Quick Start and Regulatory Guide

QSG 210072 A10



20 Rue Georges Claude - ZI Les Milles
13290 Aix-en-Provence FRANCE
T. +33 (0)4 42 65 25 65 F. +33 (0)4 42 51 57 32

coppernic.fr

SAS AU CAPITAL DE 100 000 EUROS • RCS : AIX 509 059 572
SIRET : 509 059 572 00024 • APE 6201Z • TVA : FR 58 509 059 572

Mobile enrollment backpack

Quick Start and Regulatory Guide

QSG 210072 A10

SAFETY PRECAUTIONS

- The items supplied with the device and any available accessories may vary depending on the region.
- The supplied items are designed only for this device and may not be compatible with other devices.
- Appearances and specifications are subject to change without prior notice.
- Additional accessories can be purchased from your local COPPERNIC retailer.
- Using unapproved accessories may cause performance issues and malfunctions that are not covered by the warranty.

AVAILABILITY OF ALL ACCESSORIES IS SUBJECT TO CHANGE.

Mobile enrollment backpack

Quick Start and Regulatory Guide

QSG 210072 A10

WHAT'S IN THE BOX ?

All items are to be ordered separately with the references below.

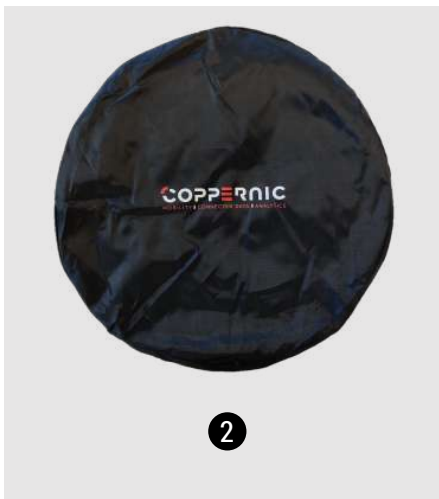

1 BACKPACK-BL-40L
BLACK

3 SOLAR-PACK-63W-5V-12V
SOLAR PANEL

5 PLM230131
REFRESHING CASE FOR ID
PLATFORM BATTERY CHARGER

2 DWBG-90
WHITE DISC BACKGROUND

4 DS-BATIDP-1000
ID PLATFORM BATTERY CHARGER
WITH BATTERY

Mobile enrollment backpack

Quick Start and Regulatory Guide

QSG 210072 A10

White disc background

USING YOUR DISC BACKGROUND

1. Open the bag using the zipper
2. Take out the white disc background
3. Use it to take pictures



PACK YOUR DISC BACKGROUND

1. Hold the sides with both hands
2. Twist the sides in opposite directions (one side forward, one side backward)
3. Fold inward to become three small circles
4. Folded successfully
5. Put into the bag

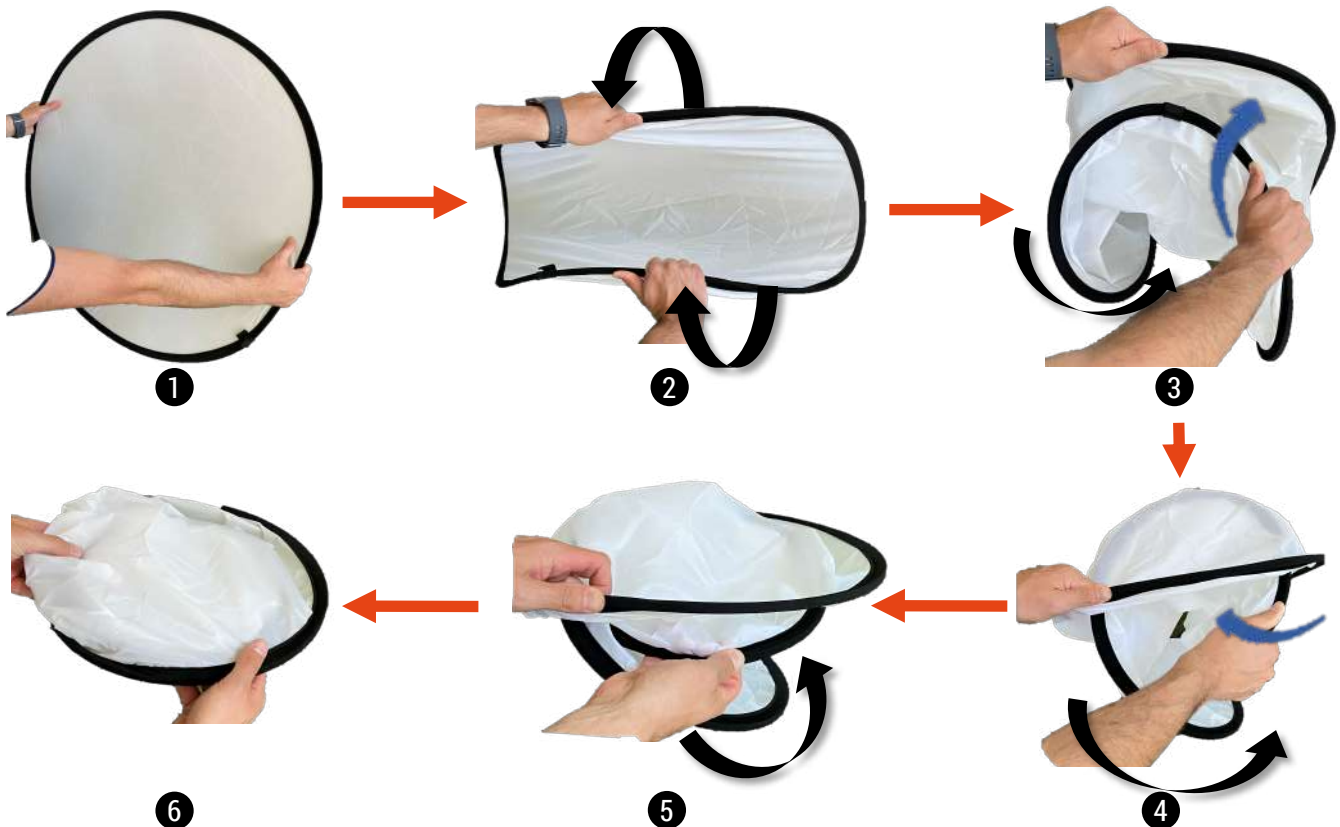

Mobile enrollment backpack

Quick Start and Regulatory Guide

QSG 210072 A10

Using the solar panel to charge the Power Bank

USING YOUR SOLAR PANEL

1. Open the bag using the Velcro fastener
2. Unfolded the solar panel
3. Place it under the maximum of luminosity

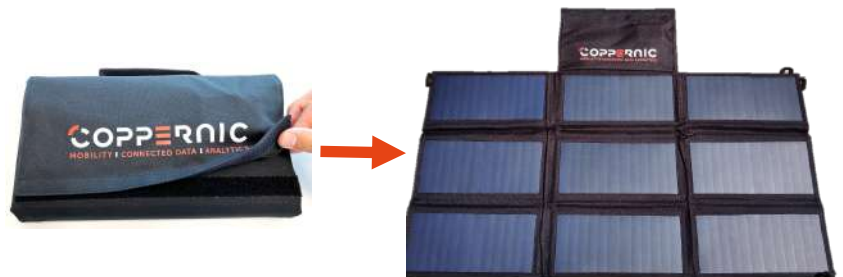

PLUG THE BATTERY CHARGER TO THE SOLAR PANEL

1. Plug the power cable inside the Jack connector of the power bank
2. Insert the battery into the batterie charger



USING THE REFRESHING CASE FOR IDP CHARGER ON HOT DAYS

1. Soak the case in cold water for 2-5 minutes to activate technology up to 4 hours of cooling



Mobile enrollment backpack

Quick Start and Regulatory Guide

QSG 210072 A10

Using the Solar Panel to charge the Power Bank

USING THE REFRESHING CASE FOR ID PLATFORM CHARGER ON HOT DAYS

1. Place the battery in the protective plastic pouch and then in the refreshing case
2. Place the refreshing case behind the solar panel to protect it from the sun



LEDS INDICATORS OF THE BATTERY CHARGER ID PLATFORM



1. Power
2. Battery charging
3. Battery charged

CHARGE MODE

When the battery is charging



- Led 1 is solid green
- Led 2 is solid red
- Led 3 is off

END OF CHARGE

When the battery is fully charged



- Led 1 is solid green
- Led 2 is off
- Led 3 is solid green

Mobile enrollment backpack

Quick Start and Regulatory Guide

QSG 210072 A10

Battery Information

Use only COPPERNIC approved batteries.

When devices are stored over six (6) months without use, some irreversible deterioration in overall battery quality may occur. Store devices at half of full charge in a dry, cool place. When storing devices for one year or longer, the charge level of battery should be verified at least once a year and charged to half of full charge.

Battery Safety

1. The area in which the units are charged should be clear of debris and combustible materials or chemicals. Particular care should be taken where the device is charged in a non-commercial environment.
2. Follow battery usage, storage, and charging guidelines found in the user guide.
3. Improper battery use may result in a fire, explosion, or other hazard.
4. To charge the device battery, the battery and charger temperature must be between 0°C~+45°C.
5. Do not use incompatible batteries and chargers. Use of an incompatible battery or charger may present a risk of fire, explosion, leakage, or the hazard.
6. Do not disassemble or open, crush, bend or deform, puncture, or shred the device.
7. Severe impact from dropping any battery-operated device on a hard surface could cause the battery to overheat.
8. Do not short circuit a battery or allow metallic or conductive objects to contact the battery terminals.
9. Do not modify or remanufacture, attempt to insert foreign objects into the battery, immerse or expose to water or other liquids, or expose to fire, explosion, or other hazard.
10. Do not leave or store the equipment in or near areas that might get very hot, such as in a parked vehicle or near a radiator or other heat source. Do not place battery into a microwave oven or dryer.
11. Battery usage by children should be supervised.
12. Please follow local regulations to promptly dispose of used re-chargeable batteries.
13. Do not dispose of batteries in fire.
14. Seek medical advice immediately if a battery has been swallowed. In the event of a battery leak, do not allow the liquid to come in contact with the skin or eyes. If contact has been made, wash the affected area with large amounts of water and seek medical advice.